



# Stair Fitting Issues – The Major Causes

Here are the most common reasons why correctly manufactured stairs may not fit when installed on site.

These will result in **extra time, damage, remedial works and customer care issues** to resolve. All the issues shown below will be due to the newel post being out of plumb.

## PROBLEM 1

### All Flights

The treads are level but the post is not square to the treads

**The No.1 cause of stair fitting issues**

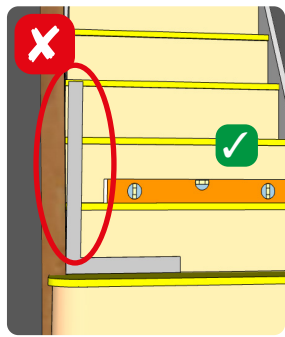

## THE CAUSE

**NEVER** use a spirit level to square a newel during assembly – always use a roofing square



## HOW TO AVOID

**ALWAYS** use a roofing square to square newels during assembly –

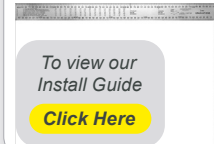

To view our Install Guide

[Click Here](#)



## PROBLEM 2

### On Winder Flights

The post is square to the treads but the treads are not level from side to side (i.e the whole stair is out of plumb)

**The No.2 cause of stair fitting issues**

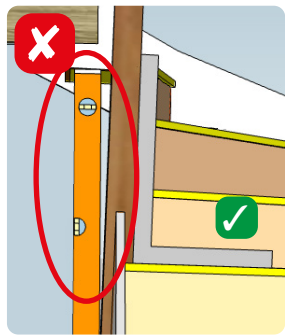

## THE CAUSE

- 1** = Opening too small or FFL too high
- 2** = Opening too big or FFL too low

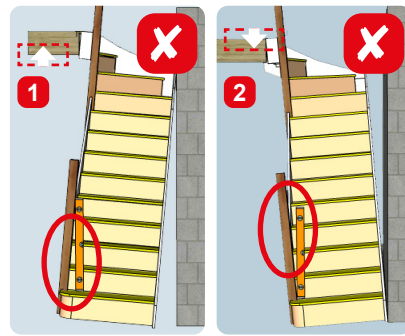

## HOW TO AVOID

Check and confirm well opening size and finished floor height prior to manufacture

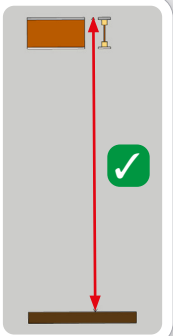
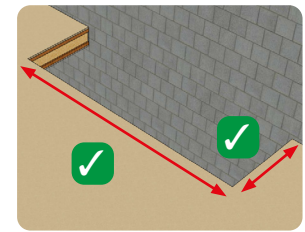

## PROBLEM 3

### On Straight Flights

The post is square to the treads but the treads are not level from front to back (i.e the whole stair is out of plumb)

**The No.3 cause of stair fitting issues**

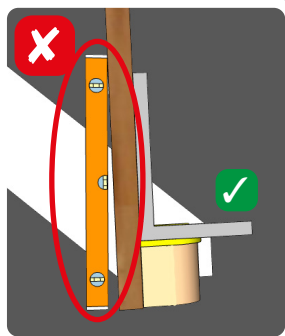

## THE CAUSE

- 1** = Finished floor level too low
- 2** = Finished floor level too high

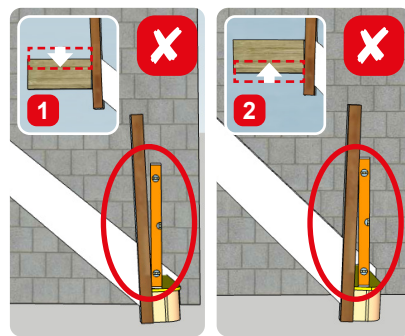

## HOW TO AVOID

Check and confirm finished floor height prior to manufacture

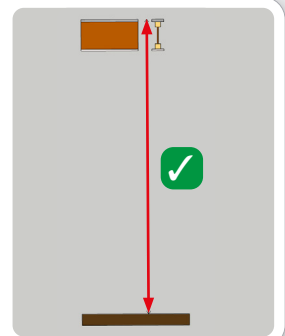

To avoid these issues, contact us for a fully integrated stair and floor-kit design service.