

Unique, market-leading door kits

A quicker, easier installation with a superior paint finish. Save up to 2 hours installation time.

Corner protection

Provides increased protection by keeping the corners and edge banding safe during transit, storage and handling.



Labels identify plot No. & specific room location



Peel clean protective film

Optionally supplied to shield the door from light wear and tear on site. Peel away once plot is ready to hand over.



Fully serviced door linings

Individually wrapped doors, machined to receive latch & hinges, pilot drilled for latch & hinge screws, and pilot drilled for wall fixings.



Split deliveries 1st & 2nd fix at no extra cost



Superior paint finish

Finished with a market-leading, water-based environmentally friendly paint that is non-yellowing.

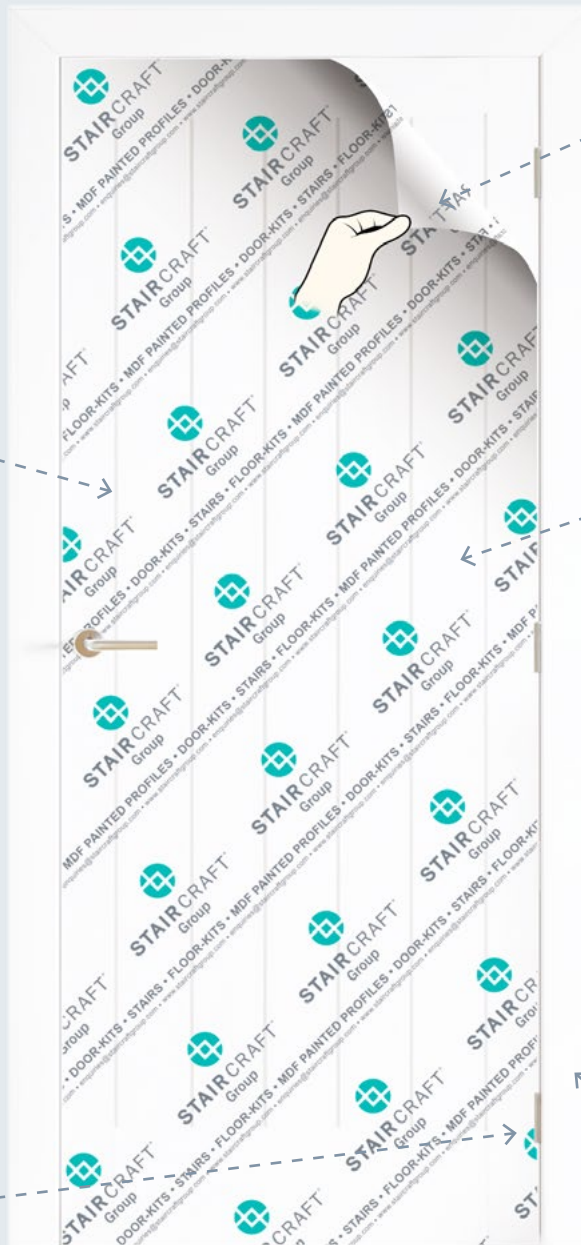

Factory fixed door hinges

Hinges assembled and fixed to doors ready to hang, and pockets are pre-cut on linings, removing the need to refit hinges during decoration.



Key:  Saves time  Saves money

Contact us today.

enquiries@staircraftgroup.com staircraftgroup.com